

## 1. Parts assembly

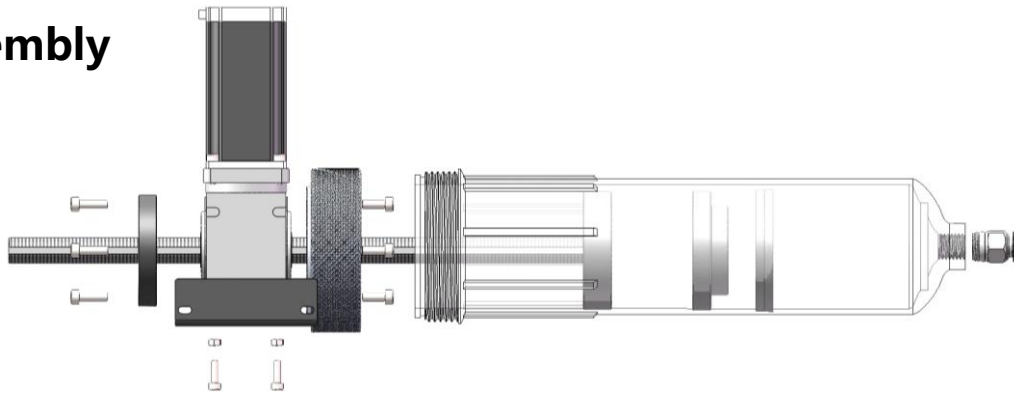

## 2. Assembly steps

2.1 Install the sheet metal, **M5-16** and **M5** nuts.

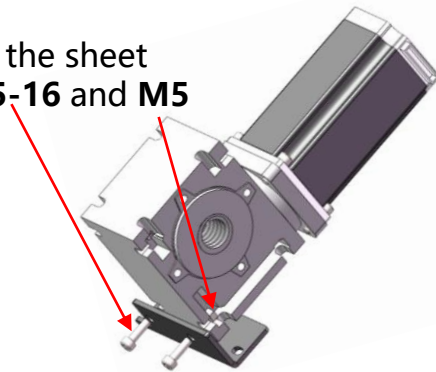

NOTE: Not included in kit.

2.2 Install the cartridge tailstock, **M6-16**.

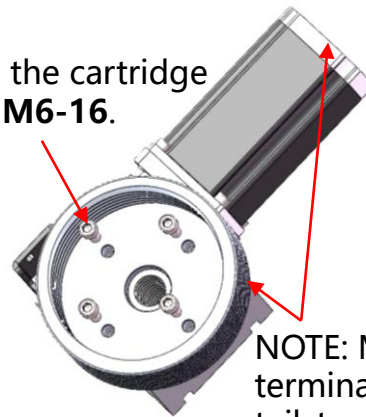

NOTE: Make no motor terminals and the cartridge tailstock on the same side.

2.3 Install push rod.

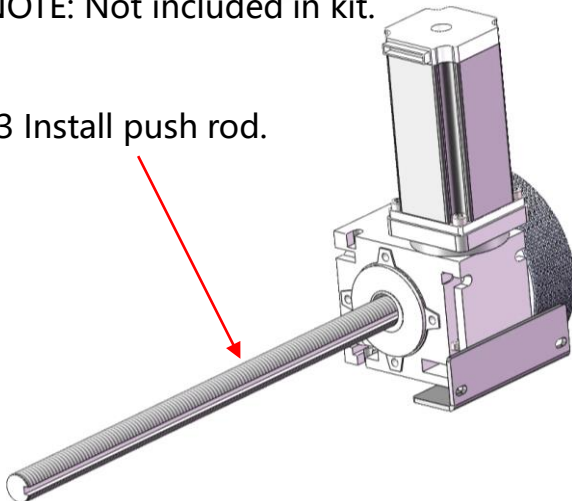

2.4 Install the anti-rotation flange, **M6-20**.

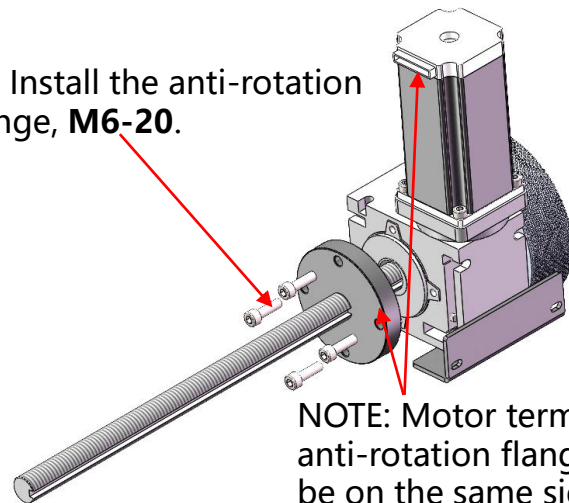

NOTE: Motor terminals and anti-rotation flange should be on the same side.

2.5 Install push block.

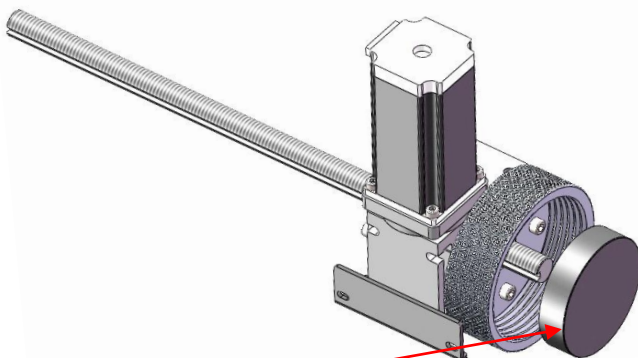

2.6 Install the piston. NOTE: the lip of the sealing ring is in contact with the clay.

